

Infrared thermometer

Please read the guide carefully before use and keep it well.
For American please refer to "°F"; for European please refer to "°C".



User's Manual

1. Summary of Infrared Thermometer

Thank you for choosing our Infrared Thermometer. The Infrared Thermometer is used to measure an objects temperature based on the relationship between temperature and measurable infrared radiation. Simply aim the unit's probe toward the surface to be measured to obtain a quick and accurate temperature. When measuring human body, the surface temperature of the forehead and convert it to the actual human temperature by an algorithm (adjustment mode).

To ensure proper use, please be sure to read this user manual carefully. Also, please pay close attention to the safety precautions.

- In order to use this product correctly, please read the user manual before use.
- In order to properly use this product, please carefully read the full text of this manual before using, in particular the "safety precautions" section.
- Please keep the manual for easy reference.

Basic Principles:

All objects with a temperature above absolute zero emit a certain amount of infrared radiation energy based on the object's temperature. The amount of radiation energy is closely related to the wavelength distribution. When a person's forehead temperature is 96.8-98.6°F(36-37°C) Fahrenheit, it emits a wavelength of 9-13 um of infrared radiation. Based on this principle, we are able to measure a person's actual body temperature just by measuring the forehead's surface temperature.

2. Safety Precautions

Warning

- Use of this thermometer is not intended as a substitute for consultation with your physician. It is dangerous for user to perform a self-evaluation and self-treatment based on the measuring result. Be sure to follow doctor's instruction.
- Keep the thermometer out of the reach of children. If the battery or any other component is swallowed, immediately call a poison center or doctor.
- Do not dispose of the battery in fire. Must be recycled or disposed properly.

Notice

- The device is precision instrument, don't drop, tramp or impose any vibration or impact on the thermometer.
- Do not touch the lens of the probe with your fingers, and do not disassemble the device by yourself.
- Before measuring temperature, please make sure the area is clear of hair or moisture (i.e. sweat).
- If you plan on measuring your temperature after exercising, eating, or bathing, please rest in a room temperature area for about 30 minutes prior to measuring the temperature for accurate results.
- For reliable and stable measurement data, please have the device placed in a room temperature area for at least 30 minutes prior to using.
- To measure temperature continuously over a duration of time, please make sure to have at least 1 minute in-

tervals between each measurement. Temperature measurements may vary slightly, hence it is recommended that you measure at least three consecutive times and then take the average of the temperatures.

- There is no absolute standard about the temperature of a person, so please try to collect the recording of individual temperature in the usual, as a reference for having a fever or not.
- Do not measure the sites of scarred tissue or tissue compromised by skin disorders, because sensing body temperature from sites of scarred tissue or tissue compromised by skin disorders can lead to not accurate temperature readings.
- Do not measure in places where there are scars or fresh wounds (especially on the head).
- Do not measure if that patient is treated with certain drug therapies.
- Do not measure when the measured sites (forehead) is exposed to direct sunlight, fireplace heat, cold compress therapies, air conditioner flow. If you are under these cases, please leave the status and wait for 30 minutes to measure.
- Do not immerse the device into water or any other liquid, and do not directly expose it to the sun.
- Make sure the measuring distance is between 1-6cm when measuring.
- Do not use a mobile or cordless phone near the thermometer when measuring.
- Do not measure after using drugs or medication, due to the fact that drugs and medicine can have impacts on the temperature of the body.
- In order to ensure the accuracy of measurement data, please don't take measurement of body temperature in strong electromagnetic interference environments (such as microwave, high frequency equipment operation environment).

3. Intended use

Indication for use

This product adopts infrared temperature measurement method to measure the temperature of forehead or ear canal.

Applicable population

Infants(except newborns), children and adults.

4. Temperature Measurement Modes and Range Description

It is used to measure the temperature of the forehead of the human body, and it can also be used to measure the temperature of the surface of objects.

5. Feature

High reliability

This product has passed the life and reliability test manufacturers internal, mean time to failure is ≥ 1000h.

A wide range of measurement

Body measurement mode: the measurement range: 89.6°F ~ 109.2°F (32.0°C ~ 42.9°C)

Object temperature measurement mode: the measurement rang: 32.0°F ~ 212.0°F (0.0°C ~ 100.0°C)

High accuracy

This product has passed the European Union and Chinese the infrared thermometer performance standards for measuring clinical requirements, measuring clinical repeatability is no more than ±0.5°F (±0.3°C)

Smart User Interface and Design

When the measured body temperature is below 89.6°F (32.0°C), the LCD will display the "Lo" prompt. If the measured body temperature is above 109.2°F (42.9°C), the LCD will display the "Hi" prompt.

When operating environment exceed the design specifications, LCD will display the Err prompt.

When the thermometer battery power is insufficient, it has low voltage icon.

Has the hardware self-test function, when hardware malfunction is detected, the Err will display prompts.

Power saving function

There is no operation after the thermometer is turned on or after the temperature measurement, the thermometer automatically enter standby state in 30s±5S.

Memory storage function

The design of 32 groups of data storage and query function, can save measurement mode and temperature measurement of your value for query.

Two-color backlight indication function

Object temperature measuring mode: Green backlight indicator

Body temperature measurement mode:

• 89.6°F ~ 99.5°F(32°C ~ 37.5°C): Green Backlight

• 99.7°F ~ 109.2°F(37.6°C ~ 42.9°C): Red Backlight

• "Lo" or "Hi" prompt: Green Backlight

6. Overall Description

Main component including

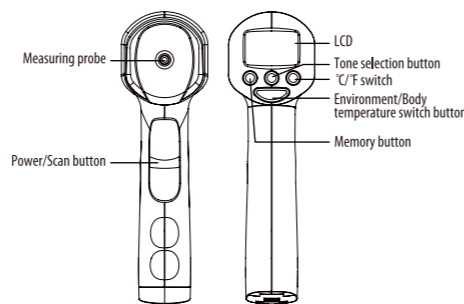

LCD display description

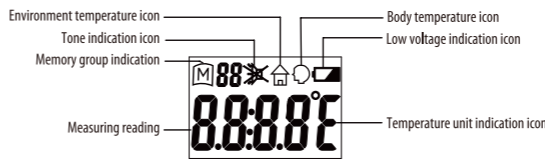

7. Operation Instruction

Preparation

1) Check battery

Replace the batteries to ensure power supply if there is low voltage icon for the thermometer.

2) Check thermometer

When you press the "power and scan" button, the system itself test its software and hardware. If there are problems, LCD will display "Err" symbol. Also, please check if the sensor lens is dirty or if there are any damaged parts prior to use.

3) In order to get accurate measurement results, put the thermometer in the measurement environment for 30 minutes.

4) Unexpected fluctuations in the ambient room temperature may decrease the accuracy of the measured results.

5) When measuring forehead temperature, make sure the measured area is clean and cleared or hair in order to ensure the accuracy.

Instruction for use

(1) forehead measurement

Place the infrared probe in front of the forehead at a distance between 1cm and 6cm, then press [Power/Scan], the sound of [beep] is heard after about 1 second and the measurement is finished, LCD display measurement results.As below

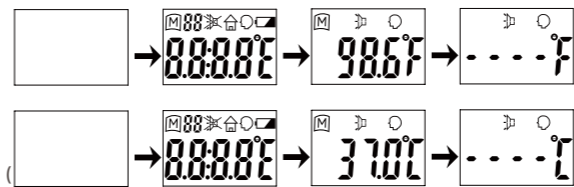

- If the ambient temperature exceeds the range of 10°C ~ 40.0°C, the thermometer shows Err;
- If the measured human temperature value is higher than 42.9°C, it shows Hi; If the measured temperature is lower than 32°C, Lo is shown.
- If 32.0°C ≤ temperature ≤ 37.5°C, green backlight lights up; If 37.6°C ≤ temperature ≤ 42.9°C, red backlight lights up; When red backlight lights up are accompanied by the continuous "BE..BE.." Sound, measurement completed, the screen will show the measured temperature value.

Notice

- When measuring the forehead temperature, you should first remove the hat or arrange the hair on the forehead to prevent the influence of measurement.
- Sweat or cosmetics on the forehead will affect the measurement accuracy. Please keep the forehead clean during measurement.
- Be careful not to shine LED light into the subject's eyes during measurement.

(2) Measurement unit selection

After starting up, press the [°C/°F switch button] to select the unit of measurement.As below

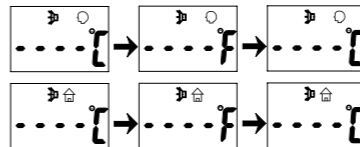

(3) Measurement mode selection

Press [Environment/Body temperature switch button] to select the object or human body temperature measurement mode.As below

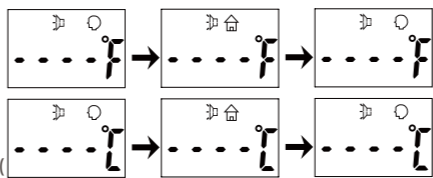

(4) Sound selection

In the power-on state, press [Tone selection button] to turn off or on the prompt tone.As below

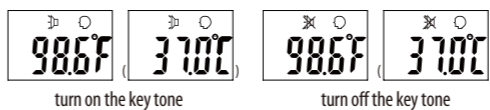

(5) Automatic shutdown

If there is no action more than 30 seconds after the temperature measurement, the thermometer will

automatically come into the standby state with no display on the screen.

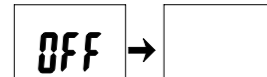

(6) Memory function

The function of data store:

The device can be store up to 32 measurement includes serial number, mode and measurement temperature, when the memory data store over the 32 groups, the system will be automatic cover by the previous measurement(the serial number 32)and so on;

The way of operation:

1. Under the power on status, Pressing the "M" button into memory query mode , the device will be display the latest memory data(Default as M1)
2. Pressing the "Power/scan" button to checking a series of measurement data, you will see the memory number displayed from 1 to 32 with the measurement temperature by LCD screen accordingly.

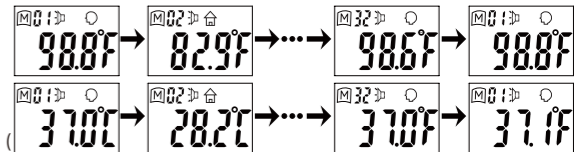

(7) Battery installment and replacement

After starting up the thermometer, the thermometer will automatically check for the batteries' power. If the battery power is too low, the screen will display a low symbol " ". If the battery has been detected to be not able to be used normally, the screen will flash the low symbol the automatically turn off after 3 flashes prompting the user to replace the batteries with new ones.

Battery replacement:

- (1) Step 1: Open the battery case and take out the old ones.
- (2) Step 2: Put the new battery to the slot and keep it fixed well, please pay attention to the electrode and don't make a mistake, then cover the case to finish the battery replacement.

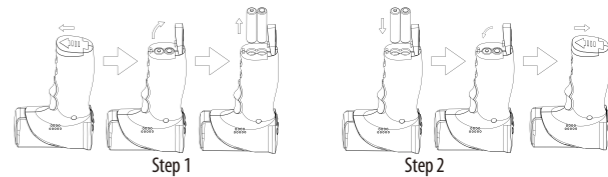

Notice:

Please observe the related national laws of disposing the old batteries and do not throw directly into the trash. Please take out the batteries if the device is not used for long periods of time. Please don't put the batteries in fire. We recommend that you choose batteries from well-known brands, to obtain the basic performance and safety guarantees.

8. Cleaning and Care

Probe tip (lens) is a most fragile and sensitive part of the thermometer. Please keep its entirety clean in order to ensure the accuracy of measurement.

The probe tip and lens are the most delicate part of the thermometer. It has to be clean and intact to ensure accurate readings.

If the thermometer is ever accidentally dirtied, use the following steps to clean the probe and lens:

- Very gently wipe the surface with a cotton swab or soft cloth moistened with alcohol. Wait for the alcohol to completely dry out before using.
- If the lens is damaged, contact the distributor.

Clean the unit body:

- Use a soft, dry cloth to clean the thermometer display and unit body.
- If very dirty, use a soft with alcohol to cleaning.

NOTES:

- Do not use abrasive cleaners.
- Don't use other non-recommended methods to perform disinfection or cleaning.
- This device is not waterproof, do not drop or submerge the device in water or any liquid.

9. Maintenance

- 1) We do not authorize any institution or individual to maintain and repair of the product. If you suspect that the products have any issues, please contact the manufacturer or distributor to handle the case.
- 2) The user must not attempt any repairs to the device or any of its accessories. Please contact the retailer for repair.
- 3) Opening of the equipment by unauthorized agencies is not allowed and will terminate any claim to warranty.

WARNING: No modification of this equipment is allowed!

10. Cleaning Instruction

Before and after each use, clean the thermometers by the solutions listed below are recommended. Please use a disinfectant cloth for cleaning. Do not immerse the whole thermometer into any liquid. Do not sterilize by boiling method, gas or steam autoclave.

Solution	Dilution with water	Method
Ethanol	70%~80%	Wipe the probe enclosure and button with the soaked cloth for 30s.

Isopropyl Alcohol	70%~90%	As above.
Glutaraldehyde	0.5%~2%	As above.

11. Calibration

The thermometer is initially calibrated at the time of manufacture. If this thermometer is used according to the use instruction, periodic re-adjustment is not required. If any time your question the accuracy of measurement, please contact distributor or manufacturer, the contact information see last page.

12. Storage

- 1) Don't put the thermometer under direct sunlight, high temperature, moist environments, flammable areas, or areas susceptible to vibration.
- 2) Remove the batteries if the device is not to be used for long durations.

13. Accessories

Only use original accessories. Check that the contents of the delivery are complete.

Quantity	Parts
1pc	Infrared Thermometer
2pcs	AAA batteries
1pc	User Manual

14. Trouble-Shooting

Troubles or error message	Checklists or situation	Countermeasures or solution
No response/ Automatically reset	The batteries are used up?	Replace new batteries.
	Battery in wrong polarity or type?	Take out the batteries and replace new ones.
	Poor battery contact	Take out batteries and reinsert them in the correct orientation
The thermometer show the symbol "Hi"	Temperature hampered by an air flux.	Please leave the area and wait for 30 minutes to measure. Re-measure
	In the forehead measurement mode: --Temperature readings too close together. --Measured the other object, such as the sunlight, the air from the fireplace. Hi: Higher than 109.2°F (42.9°C);	according to the manual.
	In the object measurement mode: --Temperature readings too close together. --The object temperature is higher than 212°F (100.0°C). Hi: Higher than 212°F (100.0°C);	
The hair and sweat prevent the temperature achievement.		
The thermometer show the symbol "Lo"	In the forehead measurement mode: --The measuring distance is too far. --Measured the other object, such as the air from the air conditioner. Lo: Less than 89.6°F (32.0°C)	according to the manual.
	In the object measurement mode: --The measuring distance is too far. --Have water vapor condenses on the lens. Lo: Less than 32°F (0°C)	
	The ambient temperature is beyond of range of measurement (10°C~40°C or 50°F~104°F)	
	The sensor or hardware is damaged	Excluding the possibility of temperature allowance first ,then send the device to your dealer for repair
	 98.6°F 37.0°C	Low batter, but you can still use it
 Lo F Lo C	Lower battery, however you can't use it	Replace the new battery.

15. Specifications

Device name	Infrared Thermometer
Model	FDIR-V22
Measurement mode	Forehead and object temperature measurement modes
Measurement site	Forehead temperature
Measuring distance	1cm ~ 6cm (0.4in ~ 2.5in)
Powersupply	d.c.3V, 2×1.5V AAA batteries
Measuring range	For forehead temperature: 89.6°F ~ 109.2°F (32.0°C ~ 42.9°C) For object surface temperature: 32°F ~ 212°F(0°C ~ 100°C)
Measuring accuracy	For forehead temperature: 35.0°C ~ 42.0°C ± 0.2°C (95.0°F ~ 107.6°F ± 0.4°F) Outside this range: ± 0.3°C (±0.5°F)
Clinical repeatability	Within ±0.5°F (±0.3°C)
Resolution of display	0.1°F/0.1°C
Operation condition temperature	Temperature: 50.0 °F ~ 104.0 °F (10.0 °C ~ 40.0 °C) Relative humidity: ≤ 95%RH Atmospheric pressure: 70 kPa ~ 106 kPa
Transport/Storage condition temperature	Temperature: -13.0 °F ~ 131.0 °F (-25.0 °C ~ 55.0 °C) Relative humidity: ≤ 95%RH, non-condensing Atmospheric pressure: 70 kPa ~ 106 kPa
Size	149x85x44mm
Weight	110g
Shelf life	5 years
High body temperature hint	≥100.4°F (≥38°C)
Grade of waterproof	IP22
Electric shock	Internally powered ME equipment
Applied part	Type BF applied part, including the whole unit
Mode of operation	Continuous operation
Software Version	V1.0

***The above specifications are subject to change without prior notice.**

Note: ASTM laboratory accuracy requirements in the display range of 96.8°F to 102.2°F(36°C to 39°C)for this thermometer is ±0.4°F(±0.2°C), whereas for mercury-in-glass thermometer, the requirement per ASTM standards E 667-86 is ±0.2°F(±0.1°C).

16. DISPOSAL



At the end of the product lifecycle, do not throw this product into the normal household garbage, but bring it to a collection point for the recycling of electronic equipment. Waste Electrical and Electronic Equipment can have potentially harmful effects on the environment. Incorrect disposal can cause harmful toxins to build up in the air, water and soil and can be harmful to human health.

NOTES:

- Handing of battery and wastes method, please act according to the native law to proceed to handle.
- Take out the battery if you are not going to use the unit for a long time.

To protect the environment, dispose of empty battery at your retail store or at appropriate collection sites according to national or local regulations.

17. NORMALIZED SYMBOLS

	Complies with the European Medical Device Regulation (EU) 2017/745, Notified Body is SGS Belgium NV.
	Authorized representative in the European Community.
	Follow the operating instructions.
	Common Warning Symbols.
	Type BF applied parts
	Batch code
	IP code of the device: this device's grade of against ingress of solid foreign objects
	Disposal in accordance with Directive 2002/96/EC (WEEE)
	Medical Device
	Manufacturer information:
	Date of manufacture

18. Electromagnetic compatibility information

Guidance and manufacturer's declaration – electromagnetic emission – for all EQUIPMENT AND SYSTEMS

Guidance and manufacturer's declaration – electromagnetic emission		
The FDIR-V22 is intended for use in the electromagnetic environment specified below. The customer or the user of FDIR-V22 should assure that it is used in such an environment.		
Emissions test	Compliance	Electromagnetic environment - guidance
RF emissions CISPR 11	Group 1	The FDIR-V22 uses RF energy only for its internal function. There for, its RF emissions are very low and are not likely to cause any interference in nearby electronic equipment.
RF emissions CISPR 11	Class B	The FDIR-V22 suitable for use in all establishments, including domestic establishments and those directly connected to the public low-voltage power supply network that supplies buildings used for domestic purposes.
Harmonic emissions IEC 61000-3-2	Class A	
Voltage fluctuations flicker emissions IEC 61000-3-3	Complies	

Guidance and manufacturer's declaration – electromagnetic immunity – for all EQUIPMENT and SYSTEMS

Guidance and manufacturer's declaration – electromagnetic immunity			
The FDIR-V22 is intended for use in the electromagnetic environment specified below. The customer or the user of the FDIR-V22 should assure that it is used in such an environment.			
Immunity test	IEC 60601	Compliance level	Electromagnetic environment - guidance
Electrostatic discharge (ESD) IEC 61000-4-2	± 8 kV contact ± 2 kV, ± 4 kV, ± 8 kV, ± 15 kV air	± 8 kV contact ± 2 kV, ± 4 kV, ± 8 kV, ± 15 kV air	Floors should be wood, concrete or ceramic tile. If floors are covered with synthetic material, the relative humidity should be at least 30 %.
Electrostatic transient / burst IEC 61000-4-4	± 2 kV for power supply lines ± 1 kV for input/output lines	± 2 kV for power supply lines	Mains power quality should be that of a typical commercial or hospital environment.
Surge IEC 61000-4-5	± 1 kV differential mode ± 2 kV common mode	± 1 kV differential mode	Mains power quality should be that of a typical commercial or hospital environment.
Voltage dips, short interruptions and voltage variations on power supply input lines IEC 61000-4-11	0 % U _i ; 0,5 cycle U _i At 0°, 45°, 90°, 135°, 180°, 225°, 270° and 315° 0 % U _i ; 1 cycle and 70 % U _i ; 25/30 cycles Single phase: at 0° 0 % U _i ; 250/300 cycle	0 % U _i ; 0,5 cycle U _i At 0°, 45°, 90°, 135°, 180°, 225°, 270° and 315° 0 % U _i ; 1 cycle and 70 % U _i ; 25/30 cycles Single phase: at 0° 0 % U _i ; 250/300 cycle	Mains power quality should be that of a typical commercial or hospital environment. If the user of the FDIR-V22 requires continued operation during power mains interruptions, it is recommended that the FDIR-V22 be powered from an uninterruptible power supply or a battery.
Power frequency (50/60 Hz) magnetic field IEC 61000-4-8	30 A/m	30 A/m	Power frequency magnetic fields should be at levels characteristic of a typical location in a typical commercial or hospital environment.
Note :U _i is the a. c. mains voltage prior to application of the test level.			

Guidance and manufacturer's declaration – electromagnetic immunity – for EQUIPMENT and SYSTEM

Guidance and manufacturer's declaration – electromagnetic immunity			
The FDIR-V22 is intended for use in the electromagnetic environment specified below. The customer or the user of the FDIR-V22 should assure that it is used in such an environment.			
Immunity test	IEC 60601 test level	Compliance level	Electromagnetic environment - guidance
Conducted RF IEC 61000-4-6	3 Vrms	3V	Portable and mobile RF communications equipment should be used no closer to any part of the FDIR-V22 , including cables, than the recommended separation distance calculated from the equation applicable to the frequency of the transmitter. Recommended separation distance $d = \left[\frac{3.5}{v_i} \right] \sqrt{P}$ $d = \left[\frac{12}{v_i} \right] \sqrt{P}$ $d = \left[\frac{3.5}{E_1} \right] \sqrt{P}$ 80 MHz to 800 MHz $d = \left[\frac{7}{E_1} \right] \sqrt{P}$ 800 MHz to 2.7 GHz where p is the maximum output power rating of the transmitter in watts (W) according to the transmitter manufacturer and d is the recommended separation distance in metres (m). ⁶ Field strengths from fixed RF transmitters, as determined by an electromagnetic site survey, ⁹ should be less than the compliance level in each frequency range. ⁹ Interference may occur in the vicinity of equipment marked with the following symbol:
	Radiated RF IEC 61000-4-3	150 kHz to 80 MHz 6 V in ISM and amateur radio bands between 0,15 MHz and 80 MHz 10 V/m 80 MHz to 2.7 GHz	
Note 1 : At 80 MHz and 800 MHz, the higher frequency range applies. Note 2 : These guidelines may not apply in all situations. Electromagnetic is affected by absorption and reflection from struct-ures, objects and people.			

- a. The ISM (industrial, scientific and medical) bands between 150 kHz and 80 MHz are 6,765 MHz to 6,795 MHz; 13,553 MHz to 13,567 MHz; 26,957 MHz to 27,283 MHz; and 40,66 MHz to 40,70 MHz. The amateur radio bands between 0,15 MHz and 80 MHz are 1,8 MHz to 2,0 MHz, 3,5 MHz to 4,0 MHz, 5,3 MHz to 5,4 MHz, 7 MHz to 7,3 MHz, 10,1 MHz to 10,15 MHz, 14 MHz to 14,2 MHz, 18,07 MHz to 18,17 MHz, 21,0 MHz to 21,4 MHz, 24,89 MHz to 24,99 MHz, 28,0 MHz to 29,7 MHz and 50,0 MHz to 54,0 MHz. .
- b. Field strengths from fixed transmitters, such as base stations for radio (cellular/cordless) telephones and land mobile radios, amateur radio, AM and FM radio broadcast and TV broadcast cannot be predicted theoretically with accuracy. To assess the electromagnetic environment due to fixed RF transmitters, an electromagnetic site survey should be considered. If the measured field strength in the location in which the FDIR-V22 is used exceeds the applicable RF compliance level above, the FDIR-V22 should be observed to verify normal operation. If abnormal performance is observed, additional measures may be necessary, such as re–orienting or relocating the FDIR-V22 .
- c. Over the frequency range 150 kHz to 80 MHz, field strengths should be less than 3V/m.

Recommended separation distances between portable and mobile RF communications equipment and the EQUIPMENT or SYSTEM – for EQUIPMENT and SYSTEMS

Recommended separation distances between portable and mobile RF communications equipment and the FDIR-V22				
The FDIR-V22 is intended for use in an electromagnetic environment in which radiated RF disturbances are controlled. The customer or the user of the FDIR-V22 can help prevent electromagnetic interference by maintaining a minimum distance between portable and mobile RF communications equipment (transmitters) and the FDIR-V22 as recommended below, according to the maximum output power of the communications equipment.				
Rated maximum output of transmitter W	Separation distance according to frequency of transmitter m			
	150 kHz to 80 MHz outside ISM and amateur radio bands $d = \left[\frac{3.5}{v_i} \right] \sqrt{P}$	150 kHz to 80 MHz in ISM and amateur radio bands $d = \left[\frac{12}{v_i} \right] \sqrt{P}$	80 MHz to 800 MHz $d = \left[\frac{3.5}{E_1} \right] \sqrt{P}$	800 MHz to 2.7 GHz $d = \left[\frac{7}{E_1} \right] \sqrt{P}$
0.01	0.12	0.20	0.035	0.07
0.1	0.38	0.63	0.11	0.22
1	1.2	2.00	0.35	0.70
10	3.8	6.32	1.10	2.21
100	12	20.00	35	70
For transmitters rated at a maximum output power not listed above the recommended separation distance d in metres (m) can be estimated using the equation applicable to the frequency of the transmitter, where P is the maximum output power rating of the transmitter in watts (W) according to the transmitter manufacturer. Note 1 : At 80 MHz and 800 MHz, the separation distance for the higher frequency range applies. Note 2: These guidelines may not apply in all situations. Electromagnetic propagation is affected by absorption and reflection from structures, objects and people.				

19.WARRANTY

In case of any serious incident that has occurred in relation to the device should be reported to the manufacturer and the competent authority of the member state.

We provide one year warranty starting from the date of purchase. Please refer to the following situations that are excluded from the free repair services within the warranty period.

1. All damages caused by disassembly and repair of the device by yourselves.
2. All damages caused by dropping the device during usage, or transport.
3. All damages caused by improper usage of the device and not following the instructions on the user manual.

Please contact after-sales service and support and enclose your product purchase receipt while claiming for warranty services.

Location of purchase:

Contact number:

Date of purchase:



Famidoc Technology Co., Ltd.
Add.: No. 212 Yilong Road, Hexi Industrial Zone, Jinxia, Changan Town, Dongguan, Guangdong Province, 523853, P.R. China.
Tel.: +86-769-89272488
Fax: +86-769-89272498
Website: www.famidoc.com



Name: Shanghai International Holding Corp. GmbH (Europe)
Address: Eiffestrasse 80, 20537 Hamburg, Germany