

iProven Premium Dual Mode Thermometer

Measure forehead and ear temperature accurately with the same device

DMT-77BT

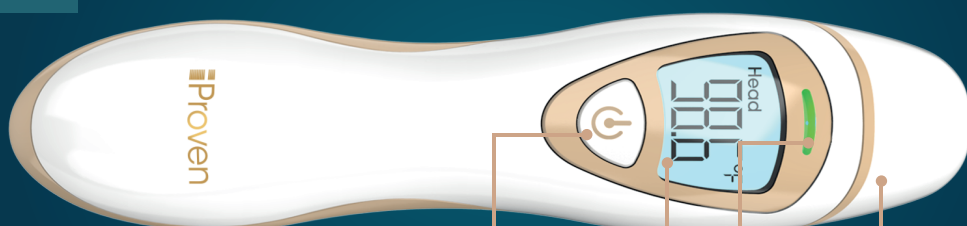

Start Button

LCD screen

Colored alert & memory button

Detachable cap to switch to ear mode

The device is intended for measuring body temperature via forehead and ear, and measuring ambient/object temperature. Do not use this device for anything other than its intended purpose.

Forehead measurements

How to do a forehead measurement:

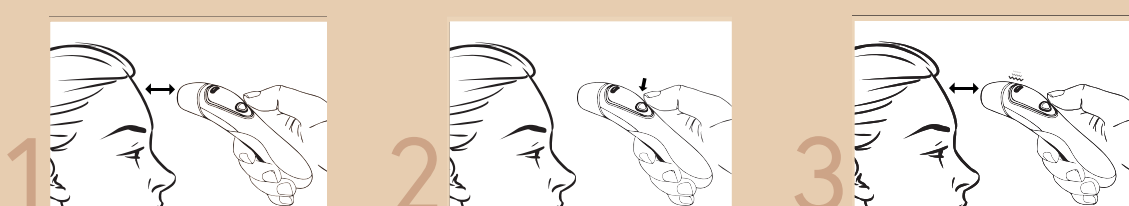

1 Point the forehead thermometer towards the middle of the forehead at around 1 inch distance.

2 Press the main button.

3 The thermometer will take a second to calibrate before measuring your forehead temperature. The thermometer will buzz once your results are ready.

Since forehead temperature fluctuates and can be influenced by outside factors, the DMT-77BT carefully calculates the ambient temperature before measuring. It takes a second longer to receive your first result, and then gives you the most accurate measurement possible.

Why does forehead temperature fluctuate?

Your forehead is not protected from outside influences. Walking outside on a cold winter day or a hot summer day can change the temperature of your forehead very easily, way easier than the temperature inside your ear. Washing your face will also influence the temperature. This is why we are so proud that this device can measure your body temperature via the forehead. The DMT-77BT calibrates first, to get the most accurate reading possible.

Want to be 100% sure no external factors have influenced your temperature reading? Do an ear measurement as well!

Ear measurements

How to do an ear measurement:

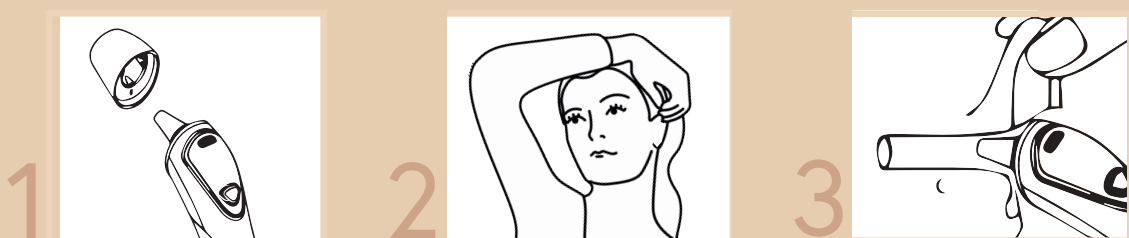

1 Take off the cap of the thermometer to switch to ear mode. Press the main button.

2 Pull the ear up and hold it to straighten the ear canal. Do not use the ear-mode on babies under the age of 6 months.

3 Insert the sensor and press the button. Wait a second till you feel it buzz and read your result.

The sensor measures the temperature of your eardrum. Since your eardrum lays deep inside your ear it is a great place to measure your body temperature. It does not get influenced by outside factors. The thermometer does not need to be calibrated for an ear measurement. Earwax might obstruct the infrared reading of your eardrum. If you have a lot of earwax, take a forehead measurement for a more accurate result. If you have an ear infection there is a high chance the temperature of your eardrum will be warmer than your actual body temperature. In case of an ear infection, do a forehead measurement instead.

Ear temperature measurement is recognized as highly accurate by doctors and used in hospitals around the world. At iProven we decided to combine this clinically accurate way of measuring with the quick and easy no-touch forehead method.

! Things that can influence your body temperature:

- Taking a shower or bath
- Exercising
- Powerful emotions
- Sunbathing
- Being outside in wind and/or rainy weather

To make sure you measure your true body temperature when any of the above occurs, relax and wait 20 minutes before measuring.

More advice on accuracy

The sensor of the DMT-77BT is basically like a little camera that 'sees' temperature. To make sure it's able to read your temperature correctly, it is important to keep the lens clean. An obstructed lens can make your reading inaccurate.

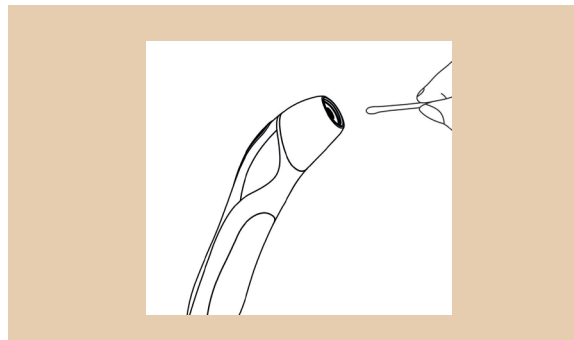

How to clean the lens:

Before cleaning, always remove the batteries from the device. Take a microfiber cloth and make it slightly wet. Carefully remove any dirt off the lens surface. You can use a cotton swab or the corner of the cloth to cautiously remove any dirt stuck to the edges of the lens.

! Warning:

Don't use any abrasive cleaning products. Do not immerse the device in liquid. If you want to use a disinfectant, we recommend Isopropyl alcohol solution (concentration: 70%) or Medicinal alcohol (concentration: 75%).

Warranty

The warranty covers any defects in materials and workings of the product under normal use during the warranty period. iProven will either replace or repair the product at no charge, using new or refurbished replacement parts. The warranty of this product covers the first 2 years from the date of purchase. In case of repair or replacement, the warranty period is the remaining warranty of the original product purchase. The warranty does NOT cover batteries or packaging, nor any problem that is caused by conditions, malfunctions or damage not resulting from defects in material or workings. Contact our friendly customer support at support@iproven.com

Vibration/Alert and LED color, what do they mean



Temperature range	Vibration	Indicator light	What does it mean?
97.7°F - 99.5°F/36.5°C - 37.5°C	1 buzz	Steady green light	Normal temperature
95.9°F - 97.5°F/35.5°C - 36.4°C	1 buzz	Steady orange light	Low temperature
99.7°F - 100.2°F/37.6°C - 37.9°C	1 buzz	Steady orange light	Elevated temperature
86.0°F - 95.7°F/30.0°C - 35.4°C	4 buzzes	Steady red light	Hypothermia
100.4°F - 111.2°F/38.0°C - 44.0°C	4 buzzes	Steady red light	Fever
32.0°F - 85.8°F/0°C - 29.9°C	1 buzz	No indicator light	Ambient/Object temperature
111.4°F - 212°F/44.1°C - 100°C	1 buzz	No indicator light	Ambient/Object temperature

The DMT-77BT has several temperature alerts to help you classify the temperature. There is the visual alert, the light above the screen changes colors, and the vibrating alert. It's silent, so you can use it to measure your baby's temperature without waking them up.

The DMT-77BT registers and warns you of elevated temperature, fever, and hypothermia. The light will change to green, orange, or red, depending on the measured temperature. See the table for which alert activates when and what it means.

Frequently Asked Questions

How do you switch between F and C?

You can use the DMT-77BT in Fahrenheit and in Celsius. To switch between the two temperature scales: take off the battery cover on the back of the device. You can do so by sliding it downwards. Underneath the batteries you will find a little black switch that will change the temperature scale if you flip it.

What batteries does it need?

Two pieces of AAA-type alkaline batteries you will find at your local grocery store. Place the batteries as shown at the bottom of the battery compartment.

How do you access the memory files?

The colored light is also a button. Press it to check your last result and press it again to see the result before that. The DMT-77BT remembers 20 measurements.

How do I measure the temperature of an object?

Use the forehead mode. Point the thermometer towards the object at around one inch distance and press the button.

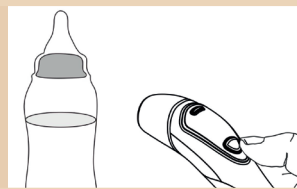
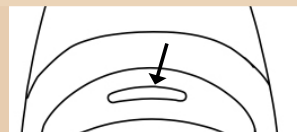
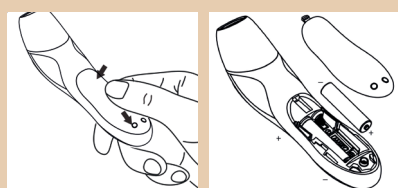
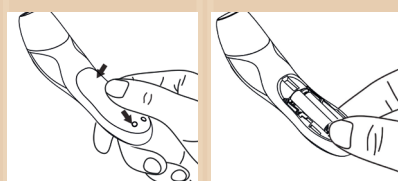

Caution

- Don't shake or drop the device, this can cause irreversible damage to the device.
- Store the device at room temperature for best accuracy.
- Never hold the device underwater nor submerge it in liquid.
- If the device won't be used for a while, remove the batteries.
- Do not give the device to children under the age of 3. It can be used to measure their temperature, but only by adults.
- Do not let children under the age of 3 hold it. The device has small parts that can be a choking hazard. Do not use on babies under 6 months old.

Maintenance & preventive inspection of the DMT-77BT

Make sure the thermometer is safe to use and regularly check the device for potential safety hazards. For example: if the lens is broken, the shell has cracks or the lens is dirty. Do not use the device if it has a potential safety hazard. Clean the device itself if it will not be used for a while.

After an ear measurement, clean the lens of the device following the method described in the section "How to clean the device" found in this manual.

Store the thermometer ideally in your living area, to have it adjusted to the same ambient temperature as the user. It should be a dry, dust-free, and well-ventilated place. Make sure that the thermometer is not exposed to sunlight.

Troubleshooting:

Problem	Possible Cause	Solution
The thermometer fails to turn on	Low battery	Change the batteries
	Polarities of the batteries are reversed	Make sure that the batteries are installed correctly
	The thermometer is damaged	Contact customer support at support@iproven.com
"Er1" is displayed on screen	The measured temperature is lower than 50°F (10°C) or higher than 104°F (40°C)	Take a measurement within the temperature range of 50°F (10°C) and 104°F (40°C).
The temperature reading is lower than the typical body temperature range	The lens is dirty	Clean the lens using a damp towel or cotton swab
	The thermometer lens cannot see the eardrum well	Make sure you pull your ear upwards to straighten the ear canal (for babies, pull the ear to the back carefully)
	The thermometer has been taken from a cold environment and used immediately	Let the thermometer acclimate for 20 minutes before measuring
The temperature reading is higher than the typical body temperature range	The thermometer is stored in a particularly warm environment	Let the thermometer acclimate for 20 minutes before measuring
	The thermometer lens is damaged	Contact customer support at support@iproven.com